

CUB LM

ACE
DESIGNERS

AceMicromatic
Group Company



HORIZONTAL TURNING CENTER

Machine Features

- Rigid bed
- Cartridge type robust spindle
- Precision Linear motion guideways on both axes
- 8 station turret
- Tailstock with hydraulic quill actuation
- 30 m/min rapid rates both axes
- Compact foot print
- Ideal for cell manufacturing layout
- Maintenance friendly

Standard Accessories

- AC spindle & axes drives
- Precision Linear motion guideways
- Bi-directional tool turret (8 station)
- Tailstock with live center
- Automatic centralized oil lubrication
- Hydraulic power chuck $\varnothing 135$ mm
- MachineConnect™
- Built-in lighting system
- Coolant system
- Drain line oil cooler
- Basic hydraulic system
- OD turning tool holder (8 nos)
- Boring bar holder (4 nos)
- Facing tool holder (2 nos)
- Set of sleeves

Optional Accessories

- Chip Conveyor - Rear mounting only
- Parts catcher
- Bar Feeder
- Gantry Automation
- Customised Solution
- MachineConnect™ software

THINK Turning®
Ace Designers

THE LARGEST MACHINE TOOL GROUP IN INDIA



Ace Designers



@acedesignersblr



@acedesigners



Follow us on :

www.acementromatic.net

Machining Range Diagram

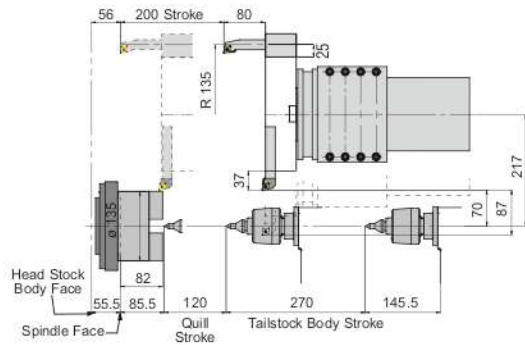

Interference Diagram

(8 Station Turret)

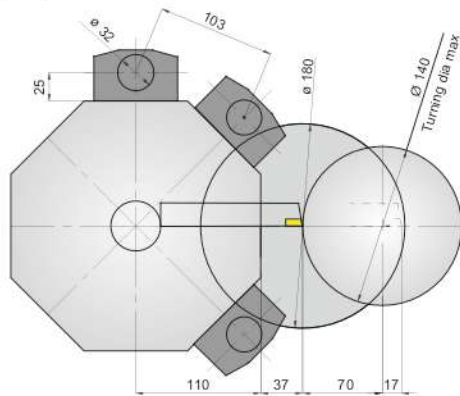

Power Torque Diagram

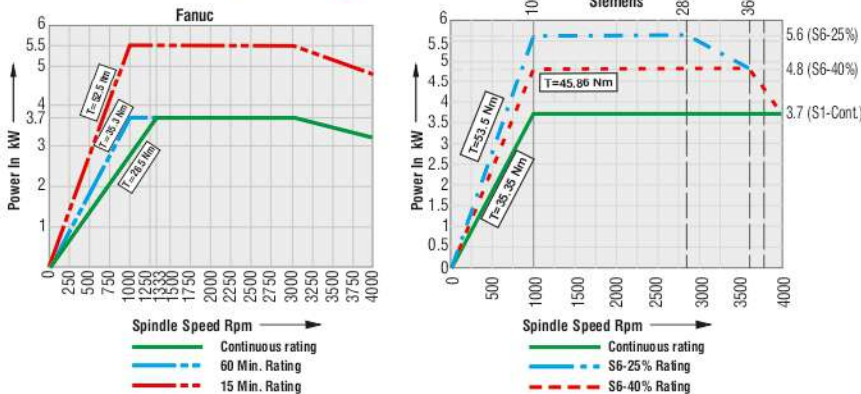

Overall View

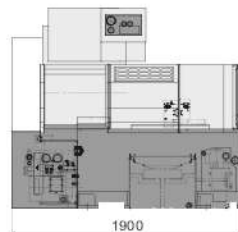
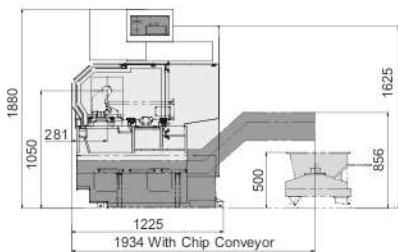

All dimensions are in mm

Manufactured by:

Ace Designers Ltd.

Registered Office - Plot No.7 & 8, II Phase, Peenya Industrial Area, Bangalore - 560 058, India

Tel : +91-80-2218 6700, Fax : +91-80-2218 6723, E-mail : info@acedesigners.co.in, CIN: U29199KA1986PLC007816

INDIA-Marketed & Serviced by **Micromatic®**

Ahmedabad +91 7925471145; Ambattur +91 98407 85521; Aurangabad +91 240 2552309; Bangalore +91 80 40200555; Belgaum +91 99800 02597; Bommasandra +91 80 27834836;

Chakan +91 2135 322002; Chennai +91 44 40440700; Coimbatore +91 422 4506183, 6588595; Delhi +91 11 22414232/ 42448095; Faridabad +91 129 4047000; Gurgaon +91 124 4745500 / 4745500;

Hyderabad +91 40 23070496; Indore +91 73899 39190, 73899 39191; Jamshedpur +91 657 6539931; Kolhapur +91 230 2460444, 2460123; Kolkata +91 33 26710158 / 2710100 / 033-64578825

Ludhiana +91 97791 28296; Mumbai +91 22 26861009/1976/7271/7272; Nasik +91 253 6610254; Pune +91 20 40712111/27479661/9662; Rajkot +91 7698000728 Ranipet +91 4172 272732;

Rohtak +91 8295043311; Rudrapur +91 95570 30224, +91 97201 06532; Tambaram +91 44 22265531; Thane +91 22 25829062 Trichy +91 431 2443066 Chandigarh +91 99141 91057 Bhiwadi +91 99581 09777

INTERNATIONAL

Germany +49 (0) 172 231 6688 Shanghai +86 (21) 586 650 31/32; Switzerland +41 32 652 58 41

Email : salesmmt@acemicromatic.com

Specifications

CUB LM

Control System	Fanuc / Siemens
CAPACITY	
Swing Over Bed	450 mm
Distance Between Centers ¹	280 mm
Maximum Turning Dia	140 mm
Between Centre Turning Dia	125 mm
Maximum Turning Length ^{1,2}	200 mm
Spindle	
Spindle Nose	Flat 110
Bore Through Spindle	36 mm
Front Bearing Bore	60 mm
Maximum Bar Capacity ²	25 mm
Maximum Spindle speed ²	4000 rpm
Spindle Motor Power (Cont./15 min. Rating) (F)	3.7 / 5.5 kw
Spindle Motor Power (Cont./S6-40%/S6-25%) (S)	3.7/4.8/5.6 kw
Full Power Range (F/S)	1333-3000 / 1000-4000 rpm
Standard Chuck Size	135 mm
Axes	
Type of Guideways	Linear Motion Guideways
X-Axis Stroke	87 mm
Z-Axis Stroke	200 mm
X & Z Axes Rapid Rate	30 m/min
X & Z Axes Motor Torque	7 Nm
Tooling	
Number of Tools Maximum	8
Boring Bar Dia Maximum	32 mm
OD Turning Tool Size	20 X 20 mm
Tailstock	
Tailstock Base Travel	270 mm
Tailstock Quill Travel	120 mm
Tailstock Quill Dia.	50 mm
Quill Taper	MT-4
Tailstock rotating centre type	Add-on
Tailstock Thrust (Max)(@ 15 Bar)	150 kgf
Coolant Tank Capacity	
Coolant Tank Capacity	110 litre
Hydraulic System	
Hydraulic Pump Capacity	12 lpm
Hydraulic Power Pack Tank Capacity	20 litre
System Pressure	30 Kg/cm ²
Overall Machine Dimensions (LXWXH)	1900 X 1225 X 1880 mm
Overall Weight (without packing)	~2200 kg

Note: Specifications correct at the time of print. Owing to continuous up-gradation of our products, the specification may change and to be reconfirmed at the time of ordering.

¹ Refer machining range diagram
(F) - Fanuc (S) - Siemens

² With Appropriate work holding

